

## VISTA EXPLODIDA – UNIDADE INTERNA

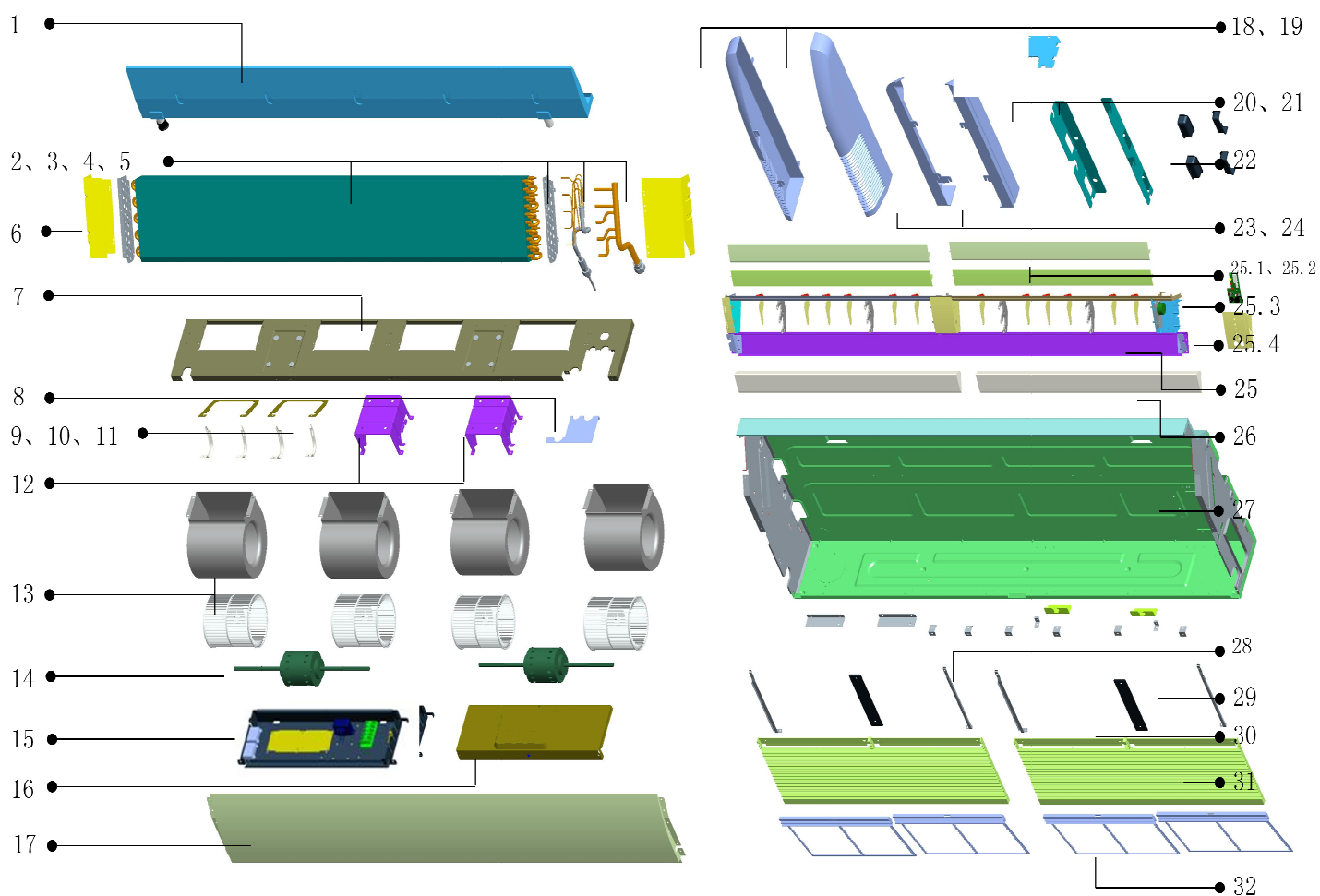

No.	Nome	Qt	BOM code
1	water pan	1	801225590003
2	evaporator	1	801525590001
3	evaporator shunt capillary components	1	801625590012
4	evaporator restore gas collector tube components	1	801625590010
5	left installation panel of evaporator	1	801225590032
6	right installation panel of evaporator	1	801225590030
7	intermediate transverse girder welding components	1	801225590041
8	pipe clamp	1	801225590025
9	right motor shaft housing gland bush	2	801225590011
10	left motor shaft housing gland bush	2	801225590012
11	electric motor board	2	801225590009
12	electric motor bracket	2	801225590010
13	wind wheel volute	4	801225590044
14	indoor fan motor	2	802400400304
15	indoor control board component	1	803325590010
15,1	electric box	1	801225590013
15,2	indoor electronic control board	1	803325190002
15,3	fan capacitor	2	802401100039
15,4	environment temperature sensors	1	802300400086
15,5	evaporator temperature sensors	1	802300400085
15,6	transformer	1	802300200068
15,7	terminal	1	802425590014
16	electric box cover	1	801225590014
17	top Cover component	1	801225590059
18	left cover plate	1	801125590027
19	right cover plate	1	801125590025
20	left hoisting installation plate	1	801225590005
21	right hoisting installation plate	1	801225590004
22	handle	4	801125590020
23	left sealplate	1	801125590028
24	right sealplate	1	801125590026
25	air outlet frame component	1	801225590054
25,1	upper air guide	2	801125590022
25,2	lower air guide	2	801125590023
25,3	display lamp panel	1	803325590003
25,4	installation box of display panel	1	801125590024
25,5	vertical step motor	1	802425400001
25,6	level step motor	1	802425400003
25,7	level step motor	1	802425400002
26	air outlet frame seal foam	2	802225590001
27	base	1	801225590047
28	filter right support plate	2	801225590023
29	filter left support plate	2	801225590024
30	filter snap-gauge	2	801225590022
31	air inlet grille	2	801125590019
32	filter	4	801125590021
33	remote controller	1	803300190014

## VISTA EXPLODIDA – UNIDADE EXTERNA

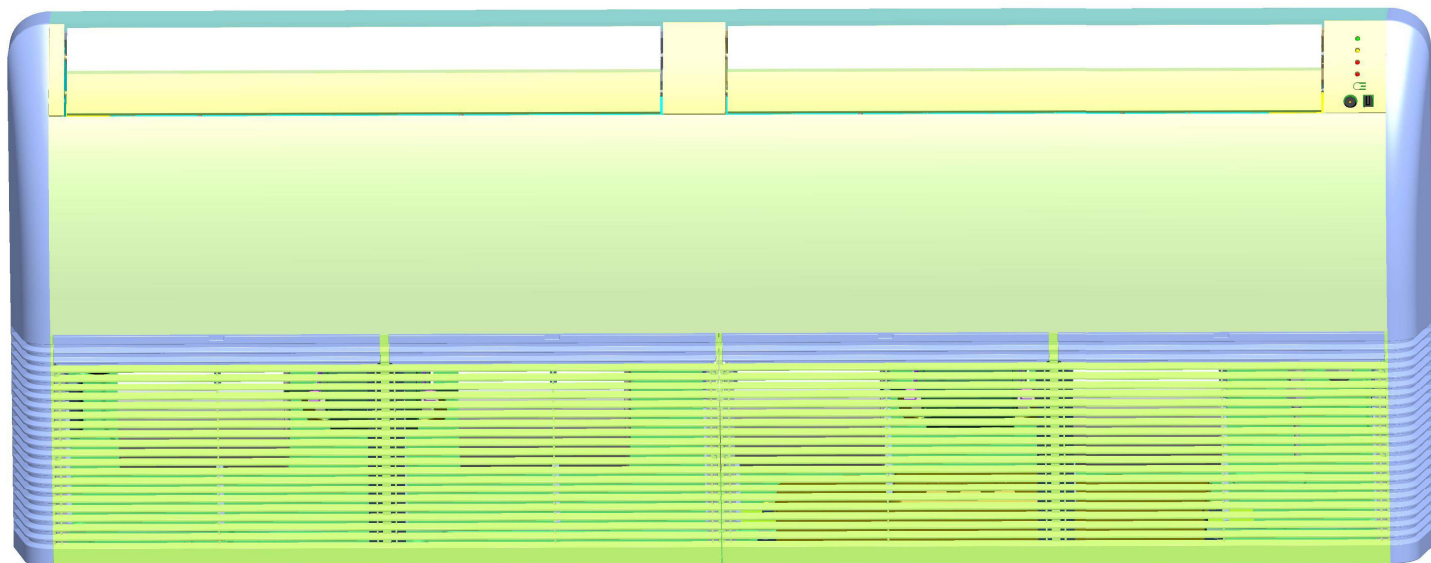
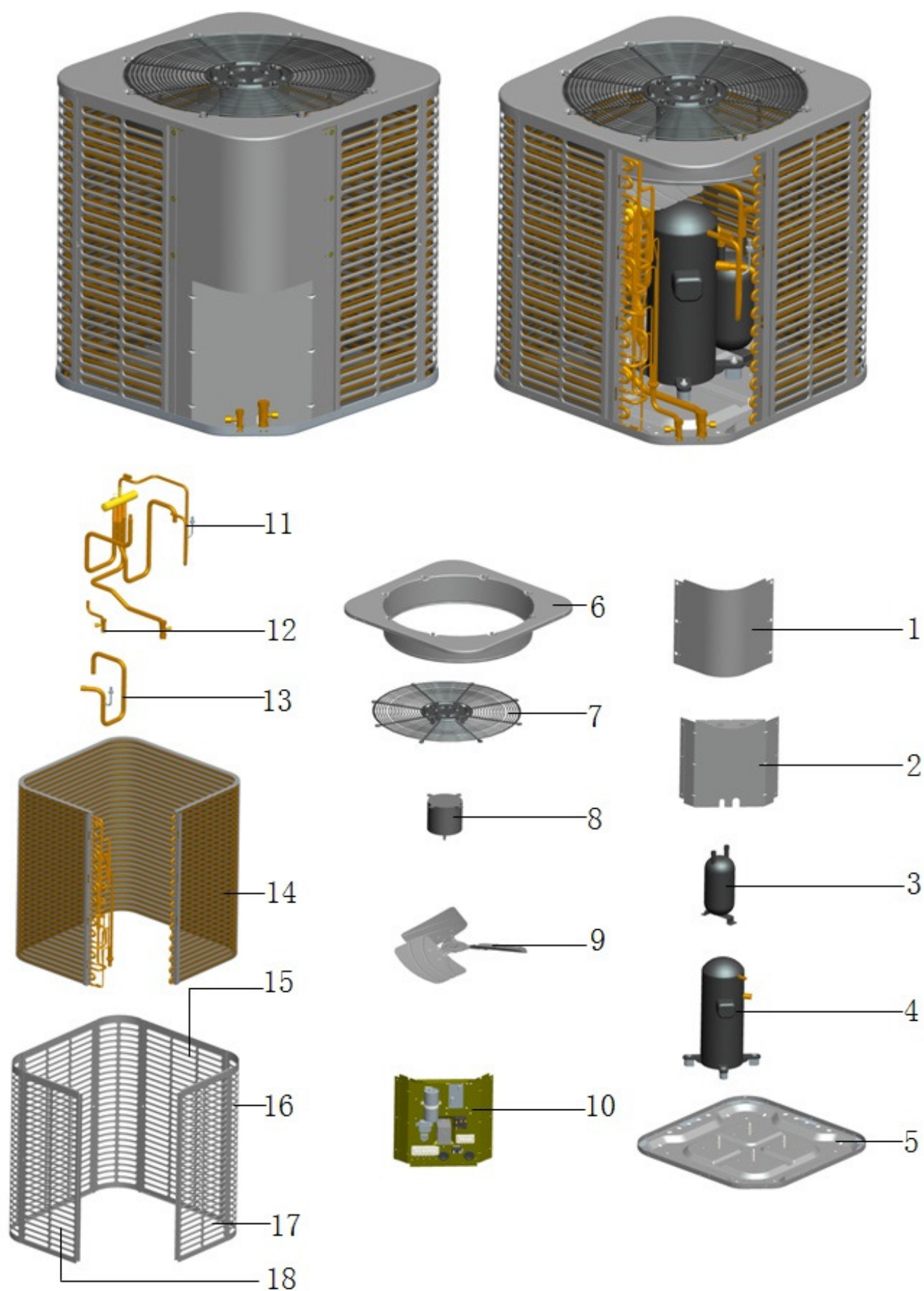

No.	Nome	Qt.	Sale code	BOM code
1	Top clapboard	1	801225490014	820025400027
2	Nether clapboard	1	801225490015	820025400027
3	Accumulator cylinder	1	801625490049	820025400027
4	Compressor	1	801400200030	820025400027
5	Underpan ass'y	1	801225490005	820025400027
6	Top cover ass'y	1	801225490018	820025400027
7	Cover net	1	801225400005	820025400027
8	Fan motor	1	802400400258	820025400027
9	Propeller fan	1	801125090001	820025400027
10	Electronic components	1	803325490007	820025400027
10,1	Installation board components	1	801225490008	820025400027
10,2	Waterproof box	2	801225490020	820025400027
10,3	Relay	1	802300100090	820025400027
10,4	Wiring terminal(Power wires)	1	802425490014	820025400027
10,5	Contactor	1	802300100098	820025400027
10,6	Compressor capacitor	1	802401000045	820025400027
10,7	Fan motor capacitor	1	802401100009	820025400027
10,8	Relay board	1	803325590004	820025400027
10,9	Temperature sensor	1	802300400097	820025400027
10,10	Phase protection board	1	803300600010	820025400027
10,11	Wiring terminal(Signal wires)	1	802419900003	820025400027
10,12	Connecting board	1	802401700346	820025400027
10,13	Connecting coil	1	802401600892	820025400027
10,14	Low-pressure switch	1	802300900042	820025400027
10,15	High-pressure switch	1	802300900046	820025400027
10,16	Discharge temp sensor	1	802301000009	820025400027
11	4-way valve ass'y	1	801625490050	820025400027
11,1	4-way valve	1	801600100036	820025400027
11,2	4-way valve connecting pipe 1	1	801625490046	820025400027
11,3	4-way valve connecting pipe 2	1	801625490044	820025400027
11,4	4-way valve connecting pipe 3	1	801625490045	820025400027
11,5	Valve body (04)	1	801625400003	820025400027
12	High-pressure valves welding components	1	801625490055	820025400027
12,1	High-pressure valves connecting pipe	1	801625490043	820025400027
12,2	Valve body 2	1	801625400001	820025400027
13	Compressor discharge pipe	1	801625490038	820025400027
14	Condenser ass'y	1	801525490007	820025400027
14,1	Condenser	1	801525490006	820025400027
14,2	Condenser left-side board	1	801225490028	820025400027
14,3	Condenser right-side board	1	801219900619	820025400027
14,4	Condenser input pipe ass'y	1	801625490052	820025400027
14,5	Condenser output pipe ass'y	1	801625490054	820025400027
15	Rear clapboard	2	801225490013	820025400027
16	Supporting board	3	801225490017	820025400027
17	Right clapboard	1	801225490016	820025400027