

VISTA EXPLODIDA – UNIDADE INTERNA

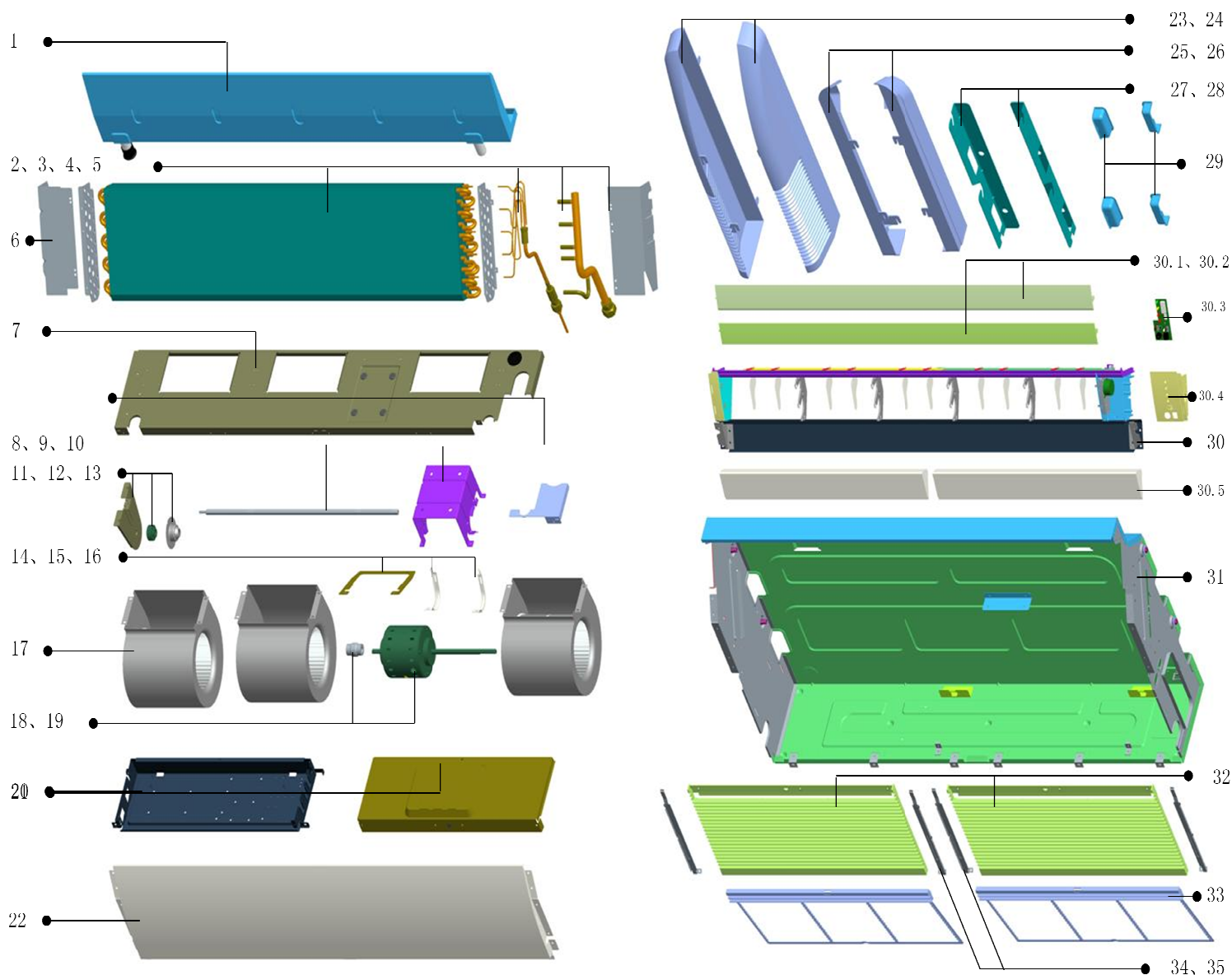

No.	Nome	Qt	BOM code
1	water pan	1	801224390017
2	evaporator	1	801524390003
3	evaporator shunt capillary components	1	801624390007
4	evaporator restore gas collector tube components	1	801624390006
5	left installation panel of evaporator	1	801224390014
6	right installation panel of evaporator	1	801225590051
7	intermediate transverse girder welding components	1	801224390019
8	coupling shaft	1	802924390001
9	electric motor bracket	1	801225590010
10	pipe clamp	1	801224390013
11	motor support plate	1	801224390020
12	bearing block	1	801119900417
13	wind leaf fixed board accessories	1	801220690041
14	electric motor board	1	801225590009
15	right motor shaft housing gland bush	1	801225590011
16	left motor shaft housing gland bush	1	801225590012
17	wind wheel volute	3	801225590044
18	coupling	1	801124390003
19	indoor fan motor	1	802400400351
20	electric box	1	801225590013
21	electric box cover	1	801225590014
22	top Cover	1	801224390010
23	right cover plate	1	801125590025
24	left cover plate	1	801125590027
25	right sealplate	1	801125590026
26	left sealplate	1	801125590028
27	left hoisting installation plate	1	801225590004
28	right hoisting installation plate	1	801225590005
29	handle	4	801125590020
30	air outlet frame component	1	801124390001
30,1	lower air guide	1	801124300009
30,2	upper air guide	1	801124300007
30,3	display lamp panel	1	803325590003
30,4	installation box of display panel	1	801125590024
30,5	air outlet frame seal foam	2	802224390001
30,6	vertical step motor	1	802425400001
30,7	horizontal step motor	1	802425400003
31	base	1	801224390002
32	air inlet grille	2	801124300005
33	filter	2	801124300006
34	filter left support plate	2	801225590024
35	filter right support plate	2	801225590023
36	electronic plate	1	803325190002
37	remote controller	1	803300190014

VISTA EXPLODIDA – UNIDADE EXTERNA

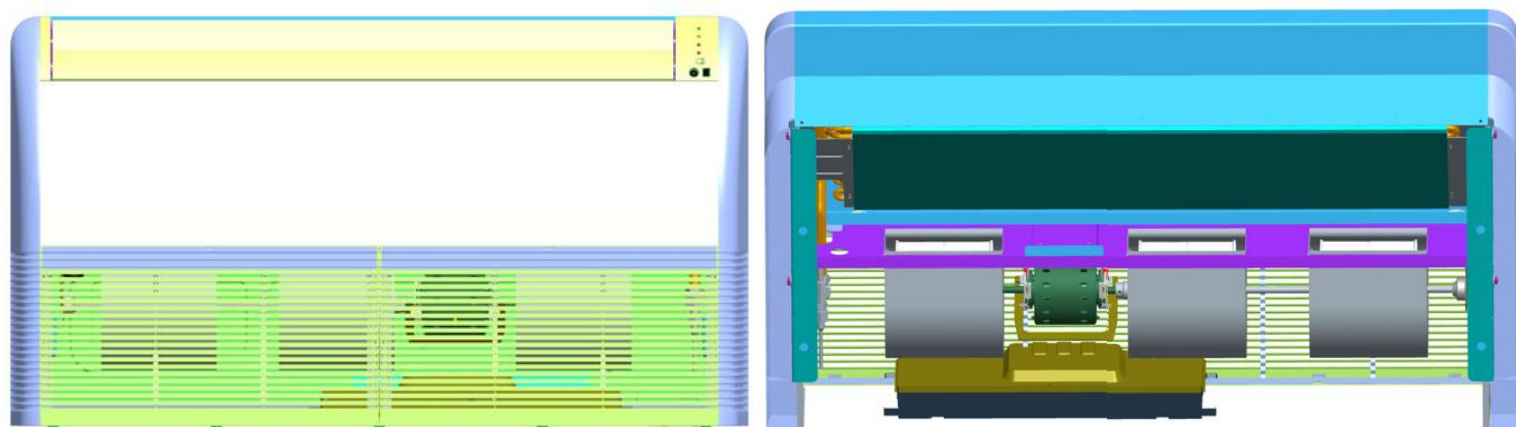
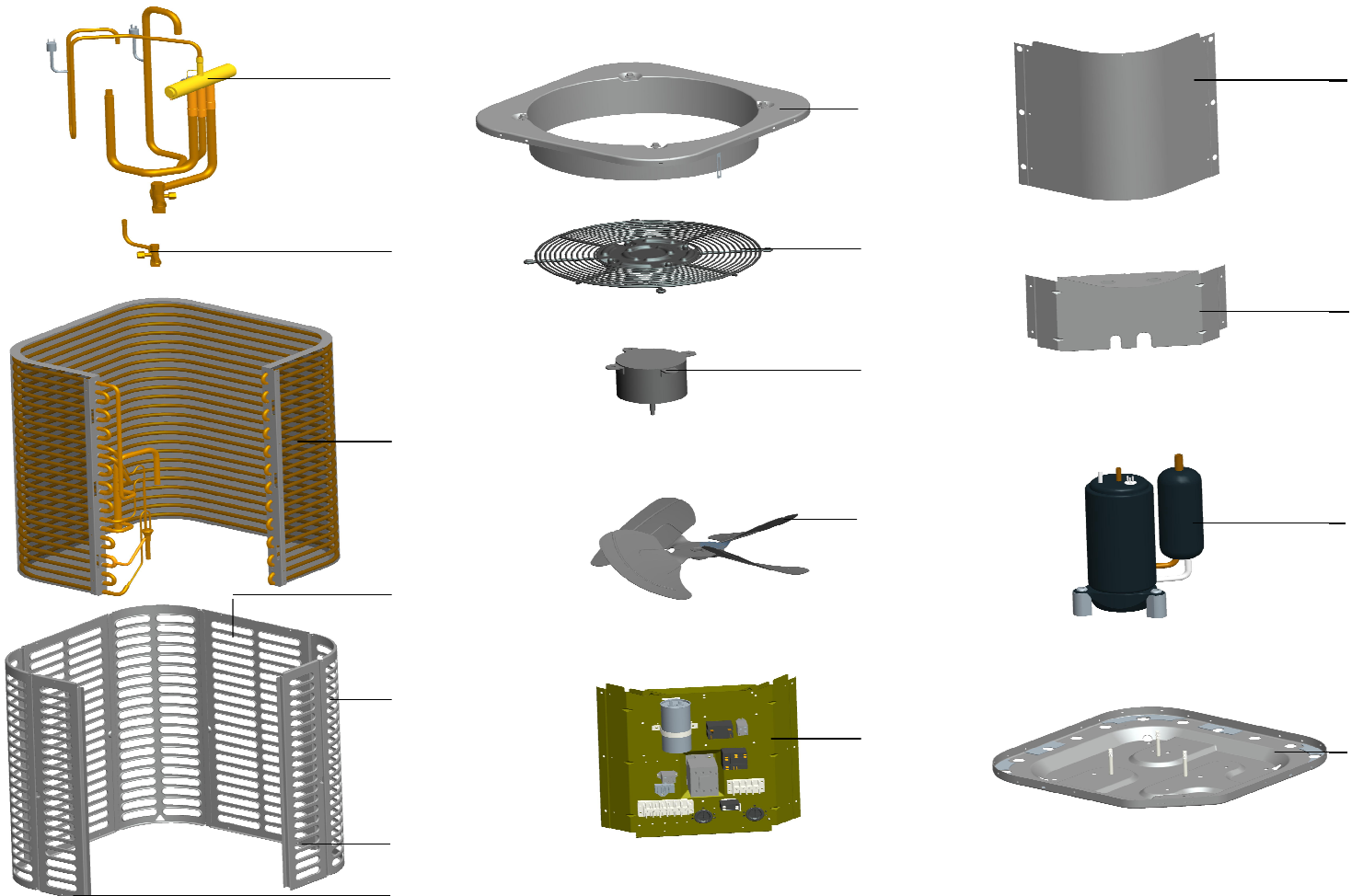

No.	Nome	Quantity	Sale code	BOM code
1	Top clapboard	1	801225490014	820024200017
2	Nether clapboard	1	801224290009	820024200017
3	Compressor	1	801401200001	820024200017
4	Underpan ass'y	1	801224290014	820024200017
5	Top cover ass'y	1	801224290007	820024200017
6	Cover net	1	801224290015	820024200017
7	Fan motor	1	802400400349	820024200017
8	Propeller fan	1	802924290001	820024200017
9	Electronic components	1	803324290003	820024200017
9,1	Installation board	1	801225490008	820024200017
9,2	Waterproof box	2	801225490020	820024200017
9,3	Relay board	1	803325590004	820024200017
9,4	Wiring terminal(Power wires)	1	802419900081	820024200017
9,5	Contactore	1	802300100098	820024200017
9,6	Compressor capacitor	1	802401000045	820024200017
9,7	Fan motor capacitor	1	802401100044	820024200017
9,8	Wiring terminal(Signal wires)	1	802425490014	820024200017
9,9	Connecting wires	1	802401600893	820024200017
9,10	Temperature sensor	1	802300400097	820024200017
9,11	Slide rail	1	802425490013	820024200017
9,12	Connecting board	1	802401600893	820024200017
9,13	Low-pressure switch	1	802300900042	820024200017
9,14	High-pressure switch	1	802300900046	820024200017
9,15	Discharge temp sensor	1	802301000009	820024200017
9,16	4-way valve coil	1	802401600895	820024200017
10	4-way valve ass'y	1	801624290023	820024200017
10,1	4-way valve	1	801600100036	820024200017
10,2	Compressor Discharge pipe	1	801624290024	820024200017
10,3	Condenser connecting pipe	1	801624290020	820024200017
10,4	Compressor suction pipe	1	801624290029	820024200017
10,5	Low-pressure pipe	1	801624290025	820024200017
10,6	Valve body (04)	1	801625400004	820024200017
11	High-pressure valves components	1	801624290019	820024200017
11,1	High-pressure valves connecting pipe	1	801624290018	820024200017
11,2	Valve body (01)	1	801625400005	820024200017
12	Condenser ass'y	1	801524290004	820024200017
13,1	Condenser	1	801524290005	820024200017
13,2	Condenser left-side board	1	801224290001	820024200017
13,3	Condenser right-side board	1	801224290002	820024200017
13,4	Condenser input pipe ass'y	1	801624290022	820024200017
13,5	Condenser output pipe ass'y	1	801624290021	820024200017
14	Rear clapboard	2	801224290008	820024200017
15	Supporting board	3	801224290011	820024200017
16	Right clapboard	1	801224290010	820024200017
17	Left clapboard	1	801224290013	820024200017